

*Feature:

- HALED patent optics design, similar to halogen light effect
- Easy and quick installation
- $PF > 0.8$, flicker free, follows new ErP
- CRI 90
- Low UGR
- Peak luminous intensity 1750cd (24°) / 1350cd (36°)
- Metal appearance, excellent heat dissipation
- Lifespan 40000 hrs, 5 years warranty
- High energy efficiency

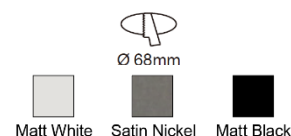

CE RoHS ErP

Technical data

Part No.	Type of installation
CTCA3408NKW/ N/ B	Recessed
Electrical specifications	
Wattage (W)	8W
AC input voltage (V)	AC200V-240V
Frequency (Hz)	50/60Hz
Flicker metric PST	0.023
Total harmonic distortion (THD)	24%
Max. no. of lamps on B16A circuit breaker	320
Max. no. of lamps on C16A circuit breaker	320
Photometric specifications	
Color temperature (CCT)	2700K \pm 150K
Chromaticity coordinate (x/ y)	0.459/ 0.412
Useful luminous flux (lm)	650lm \pm 5%
UGR	≤ 19

Power factor	0.9
Current	40mA
DC output voltage (V)	DC32-40V
Stroboscopic effect metric SVN	0.25
Dimmable	No
Max. no. of lamps on C10A circuit breaker	200
CRI/ R9	90/ >60(Min.)
Standard deviation of colour	≤ 3 SDCM
Luminous efficiency (lm/W)	81lm/ W

Photometric Information

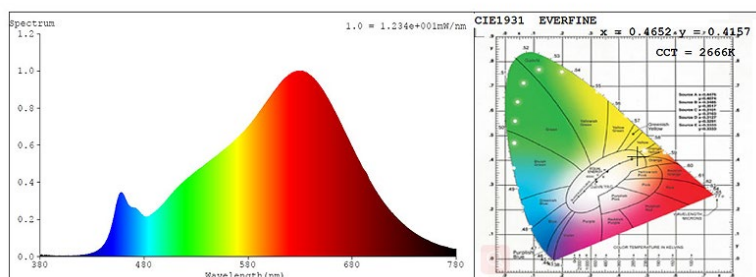

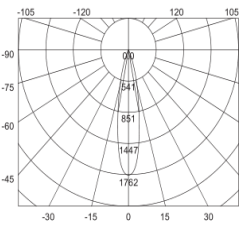
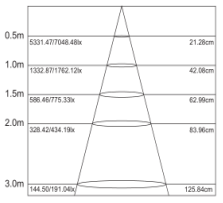
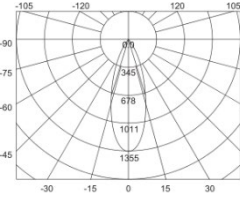
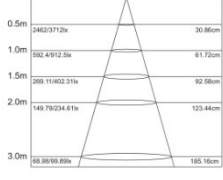
EAN	Colour	Beam angle	Peak Luminous intensity	
41228	Matt White	24°	1750cd	 
41232	Stain Nickel	24°	1750cd	
41236	Matt Black	24°	1750cd	
41176	Matt White	36°	1350cd	 
41180	Stain Nickel	36°	1350cd	
41184	Matt Black	36°	1350cd	

Mechanical specifications

Housing material Aluminium

Optical cover/ lens material AlReflector+PC+Glass

Height 55mm

Product weight 200g

Lifespan

Number of switching cycles 100,000-

L80/B10 service life at 25°C 40,000 hrs

Warranty 5 Years

Application parameters

Working temperatuer range -20~+50°C

Package

Individual package length 105mm

Individual package height 68mm

Individual package width 105mm

Gross weight (single item) 220g

Driver Internal

Housing Colour

Matt White / Stain Nickel /
Matt Black

Length/ diameter

85mm

Hole size

68mm

L70/B50 service life at 25°C

50,000 hrs

L90/B10 service life at 25°C

20,000 hrs

Storage temperature range

-20~+70°C

Shipping box height

550mm

Shipping box height

166mm

Shipping box width

240mm

Packaging unit

20pcs

Gross weight (Shipping box)

4.8kgs

Technical Drawings (mm)

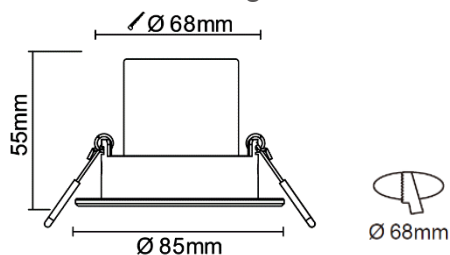

Package



85*55mm



105*105*68mm



550*20*166mm(20PCS)

Cautions:

- Power off before replacement
- Do not in violation of any fire regulations when using
- Consult competent electricians for technical support
- If the supply cord is damaged, it shall be exclusively replaced by the manufacture or his service agent o similar qualified person in order to avoid a hazard

Installation /Mounting:

Please read the entire instruction manual before using the product and reserve it for future reference. We reserve the right for any error in text or image and any necessary change made to technical data. If you have any question regarding technical problems, please contact our Customer Services.

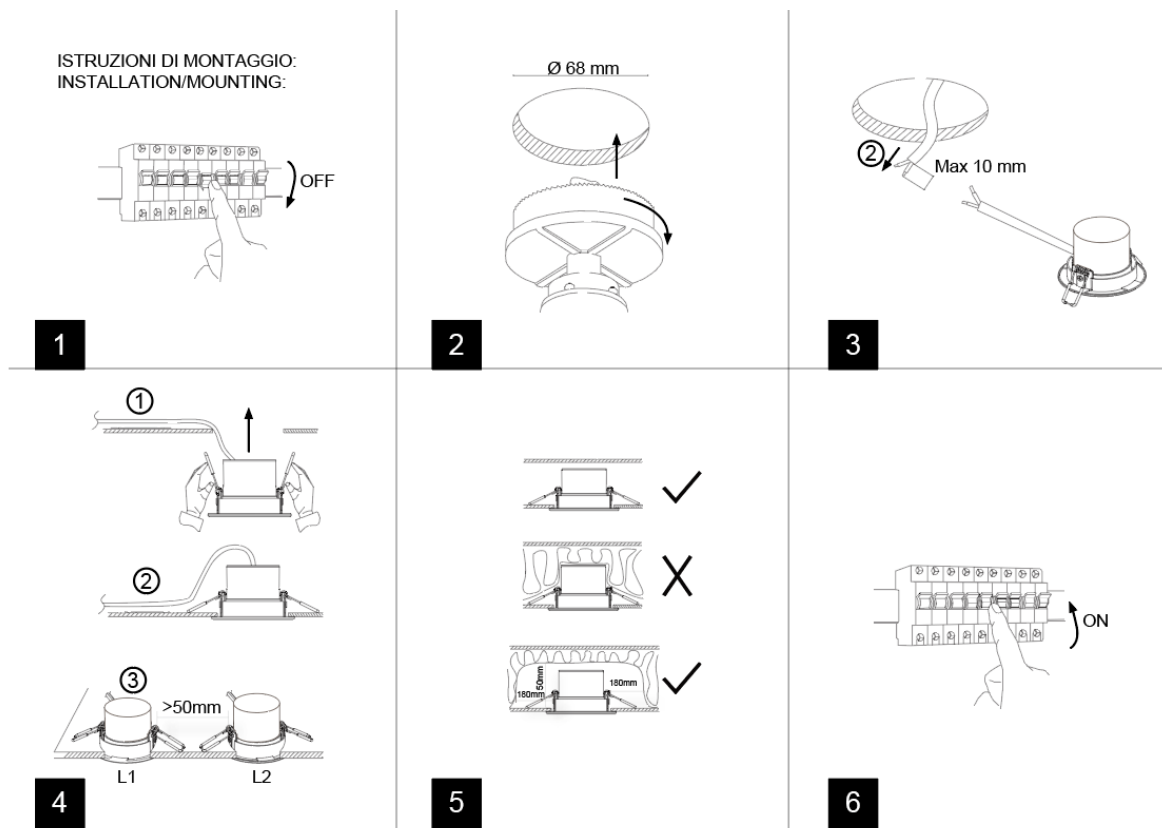

For non replacable lightsources. The light source of this luminaire is not replaceable; when the light source reaches its end of life, the whole luminaire shall be replaced"